

# Commissioning Checklist

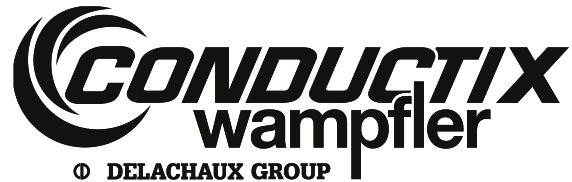

## Drive roller

Program 0380

Crane:		Location:	
Name:		Date:	
Signature:			



### NOTE!

The checklist is addressed to qualified specialists who install and commission motorized festoon systems and who are familiar with the regulations regarding work safety and prevention of accidents.



### NOTE!

All rollers have to be checked over the entire circumference!

Motorized cable trolley		1				2				3			
Roller		TL	EL	TR	ER	TL	EL	TR	ER	TL	EL	TR	ER
1	visible thickness of bandage (B) is correct												
2	no visible damages on bandage												
3	no gap between bandage and polyamide roller body												
4	no visible damage on polyamide roller body												
5	no visible damage on hub												
6	no gap between hub and shaft shoulder												
Other abnormalities													

T = towing side; E = end clamp side; R = right side\*; L = left side\*

\* direction of view: towards towing side

# Commissioning Checklist

## Drive roller

Program 0380

Step 1

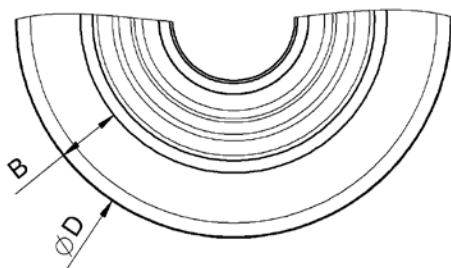

ØD	B
125 mm	~19 mm
160 mm	~24 mm

Step 2

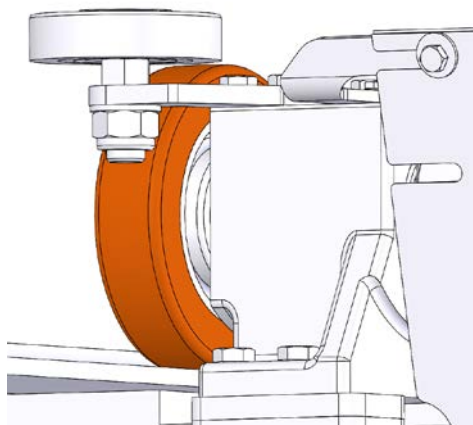

Step 3

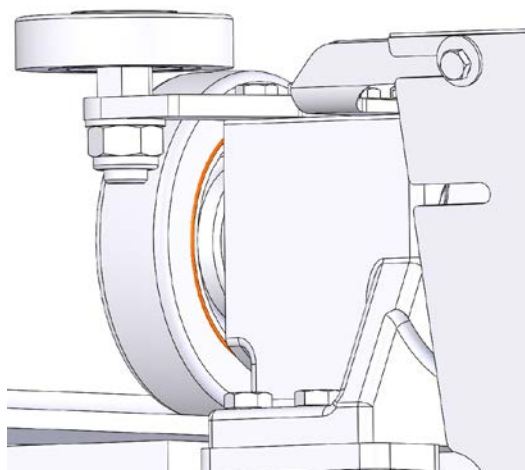

Step 4

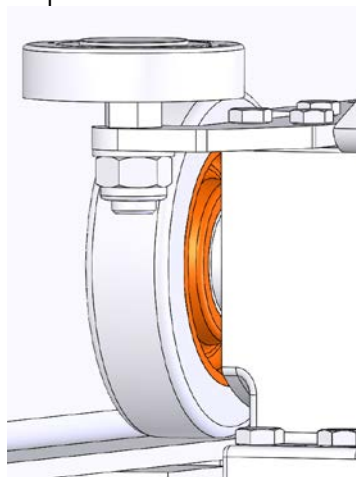

Step 5

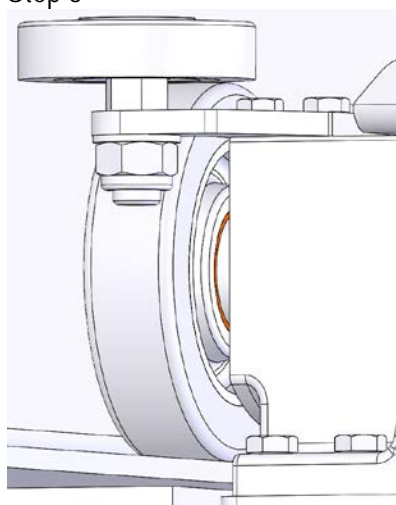

Step 6

