

Tension Roller Joint Replacement Program 0380

Order-Number
03-R004-0149

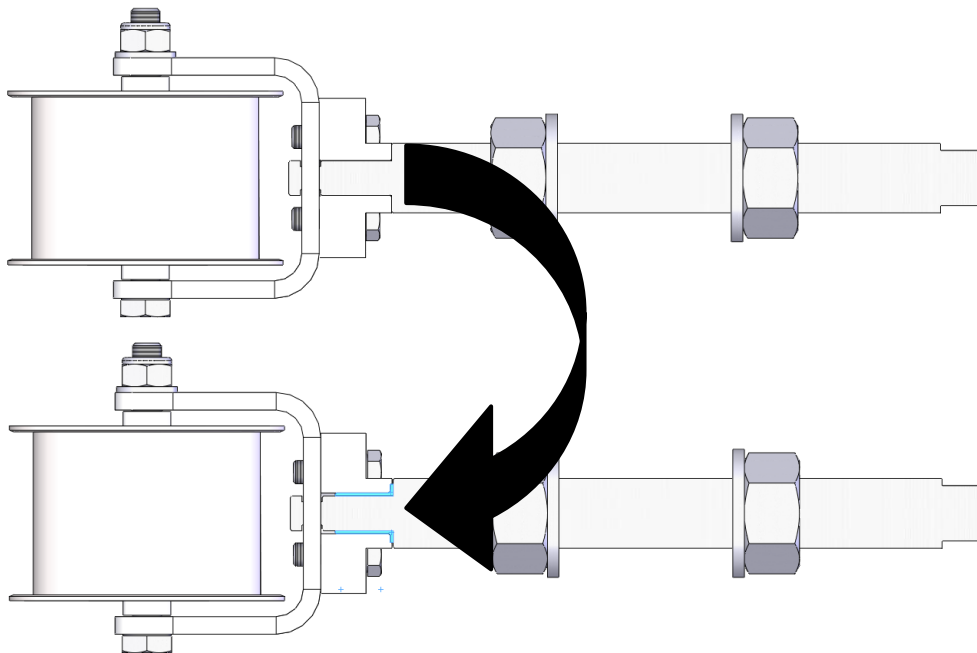

Contents

1	Required Tools	2
2	Sequency of Assembly Works	2
2.1	Remove Toothed Belt.....	2
2.2	Optional: Remove Tension Roller.....	2
2.3	Unscrew Screws M8x25	3
2.4	Dismantle Bushing and Threaded Rod.....	4
2.5	Clean Bearing Section of Threaded Rod.....	4
2.6	Assemble new Bushing with Bearing Plain Bearing Bushing	5
2.7	Attach Threaded Rod and Bushing.....	5
2.8	Insert Screws M8x25 and tighten	6
2.9	Check Function of Joint.....	6
2.10	Reattach to motorized Cable Trolley	6
2.11	Check Function.....	7

Tension Roller Joint Replacement Program 0380

1 Required Tools

- Wrench SW13
- Wrench SW36
- LOCTITE® 243
- Trummeter

2 Sequency of Assembly Works

2.1 Remove Toothed Belt

Loosen belt tension and remove belt according to MAL0300-0006-EN

2.2 Optional: Remove Tension Roller

It might be advisable to remove the whole tension roller from the motorized cable trolley for easier handling.

Tension Roller Joint Replacement Program 0380

2.3 Unscrew Screws M8x25

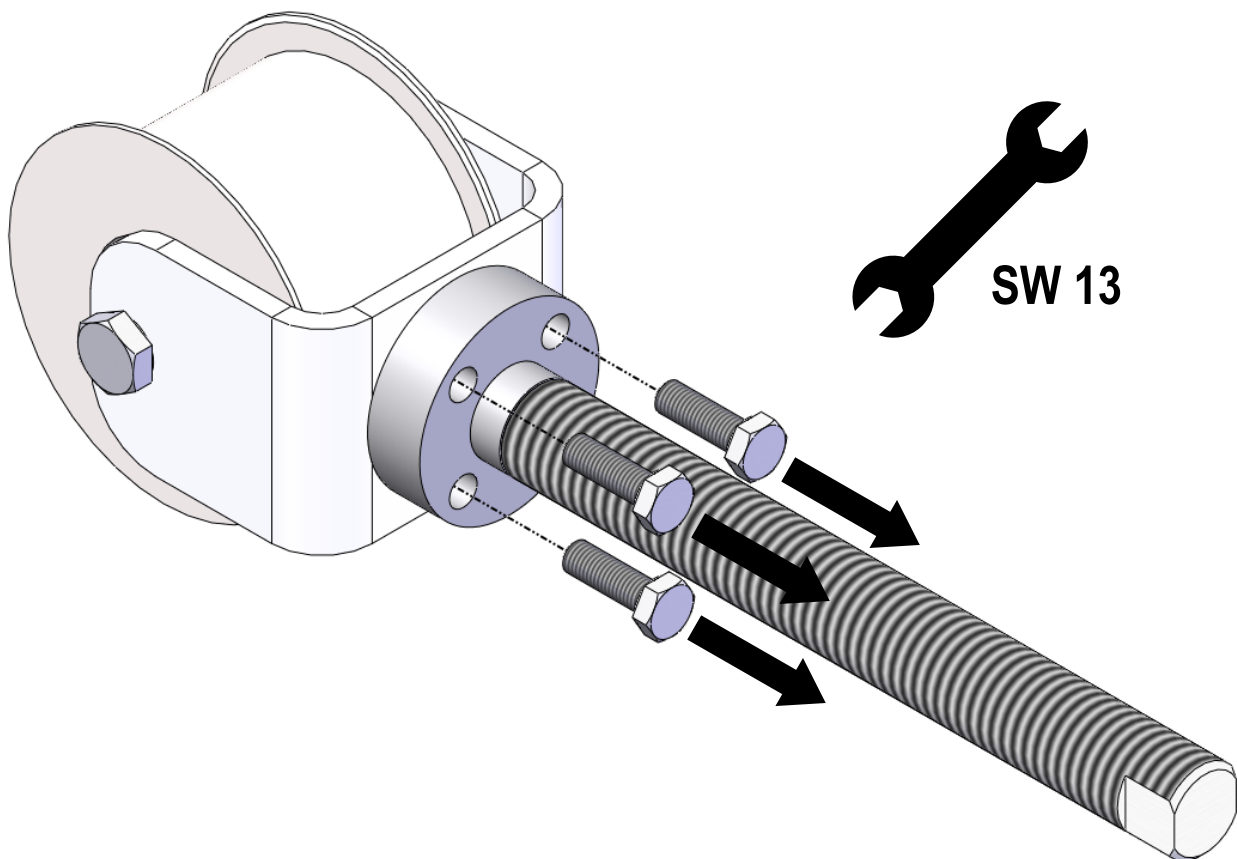

Tension Roller Joint Replacement Program 0380

2.4 Dismantle Bushing and Threaded Rod

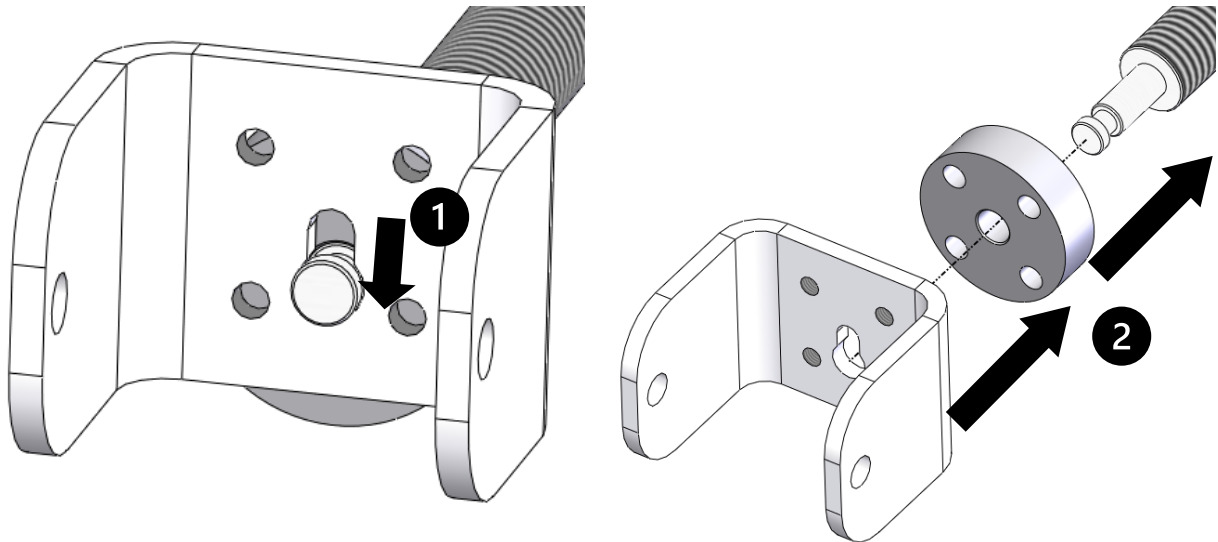

The roller itself has been hidden in the picture for better visibility. It is not necessary to disassemble the roller.

1. Slide bushing and threaded rod to wider section of keyhole
2. Pull out threaded rod (both parts are free now)

2.5 Clean Bearing Section of Threaded Rod

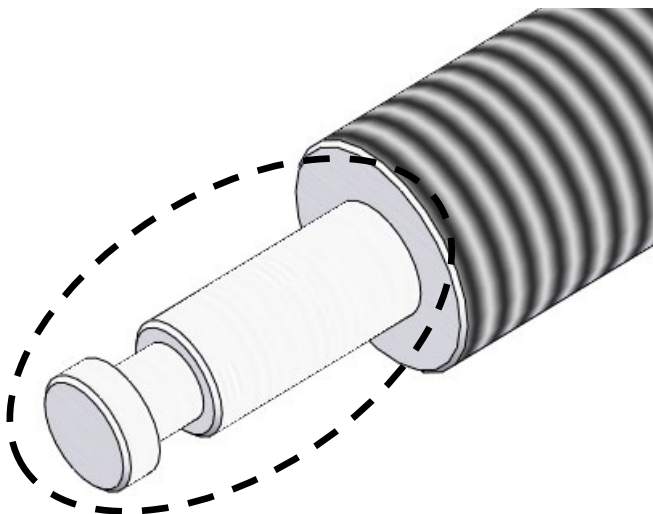

- Remove dirt
- Remove surface rust

Tension Roller Joint Replacement Program 0380

2.6 Assemble new Bushing with Bearing Plain Bearing Bushing

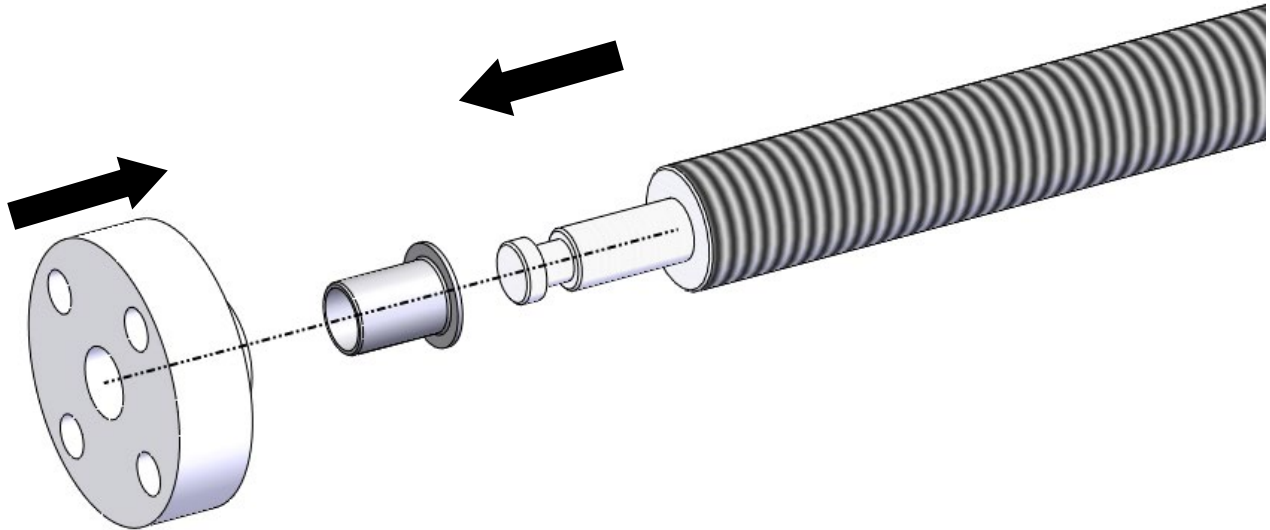

2.7 Attach Threaded Rod and Bushing

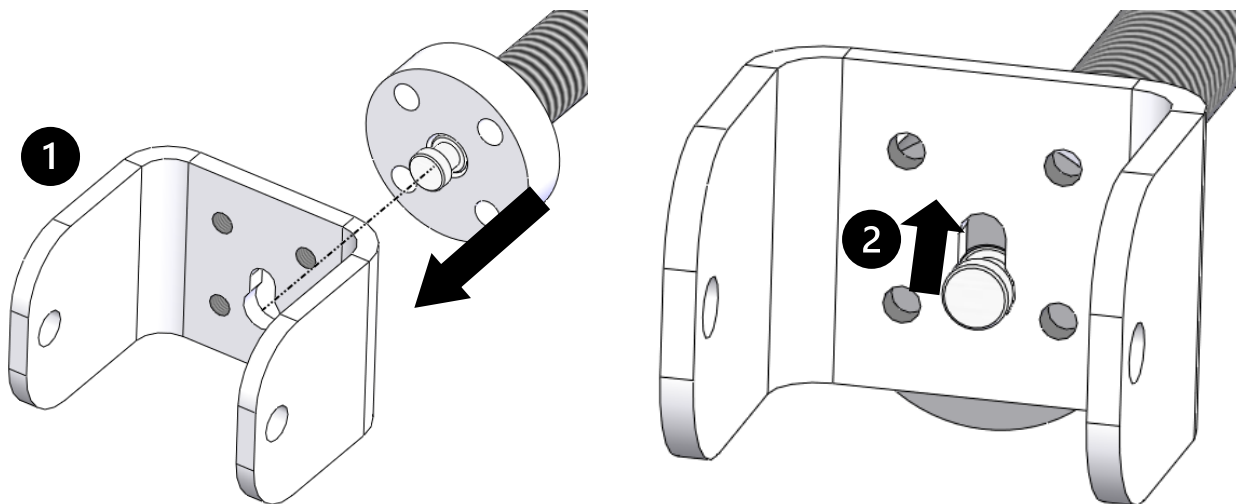

1. Insert tip of threaded rod into bracket
2. Slide threaded rod and bushing to narrow section of keyhole

Tension Roller Joint Replacement Program 0380

2.8 Insert Screws M8x25 and tighten

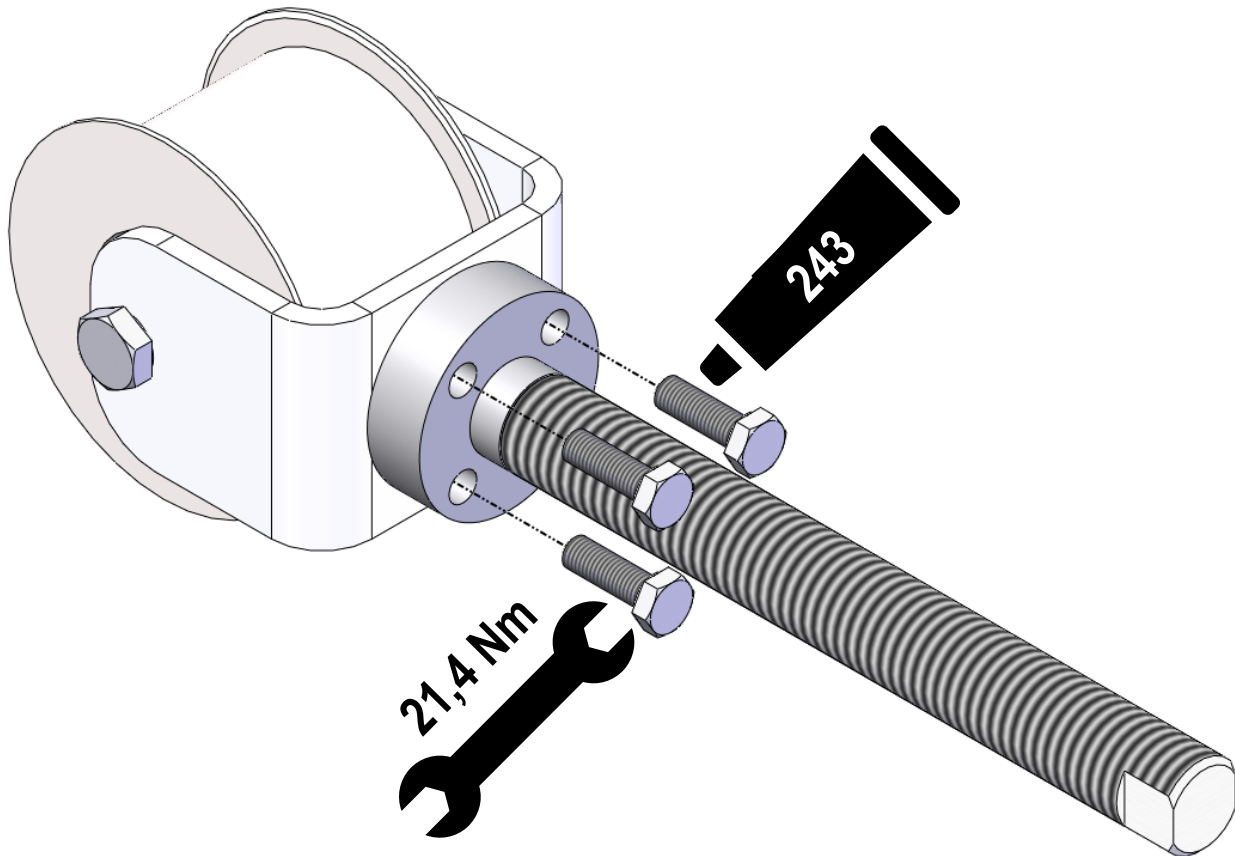

- Secure with LOCTITE® 243
- Tighten to 21,4 Nm

2.9 Check Function of Joint

Check if the newly assembled joint can be rotated smoothly.

2.10 Reattach to motorized Cable Trolley

Follow the instructions in MAL0300-0006-EN to

- reattach the tension roller,
- install new belt,
- tension belt and
- check belt tension.

Tension Roller Joint Replacement Program 0380

2.11 Check Function

- Tilt tension roller
- Move motorized cable trolley by hand

The tension must align itself as soon as the belt moves!

Conductix-Wampfler GmbH
Rheinstraße 27 + 33
79576 Weil am Rhein - Markt
Germany

Phone: +49 (0) 7621 662-0
Fax: +49 (0) 7621 662-144
info.de@conductix.com
www.conductix.com



Importer for the United Kingdom:
Conductix-Wampfler Ltd.
1, Michigan Avenue
Salford
M50 2GY
United Kingdom

Phone: +44 161 8480161
Fax: +44 161 8737017
info.uk@conductix.com
www.conductix.com